



Alcohol and Entertainment Licensing Sub-Committee (C)

Thursday 28 August 2014 at 10.00 am
Boardrooms 5 and 6 - Brent Civic Centre, Engineers
Way, Wembley, HA9 0FJ

Membership:

Members

Councillors:
Long (Chair)
Hoda-Benn
McLeish

Substitute Members

Councillors:
Ahmed, Bradley, Chohan, Duffy, Hector and
Tatler

For further information contact: Toby Howes, Senior Democratic Services Officer
020 8937 1307, toby.howes@brent.gov.uk

For electronic copies of minutes, reports and agendas, and to be alerted when the minutes of this meeting have been published visit:
democracy.brent.gov.uk

The press and public are welcome to attend this meeting

Agenda

Introductions, if appropriate.

Apologies for absence and clarification of alternate members

Item **Page**

1 Declarations of personal and prejudicial interests

Members are invited to declare at this stage of the meeting, any relevant financial or other interest in the items on this agenda.

2 Application by the Metropolitan Police to review the premises licence for 'Bar No. 8' (305 Willesden High Road, London NW10 2JT) pursuant to the provisions of the Licensing Act 2003 1 - 16

The review of the premises licence follows the expedited review of the premises that was considered by Alcohol and Entertainment Licensing Sub-Committee (C) on 5 August 2014.



Please remember to switch your mobile phone to silent during the meeting.

- The meeting room is accessible by lift and seats will be provided for members of the public.

LICENSING ACT 2003

Application for the Review a Premises Licence

Name of Applicant:	Metropolitan Police
Name & Address of Premises:	Bar 08, 305 Willesden High Road London NW10 2JT
Applicants Agent:	

1. Application

The application is for the review of a premises licence held by Tubby Ltd following an expedited review held on 5th August 2014. The premises are known as Bar 08, 305 Willesden High Road London NW10 2JT

2. Grounds for Review

The grounds for review are Crime and Disorder, public nuisance and public safety.

3. Relevant Representations

Representation has been received from Sam Lewis-Evans of Metropolitan Police.

4. Background

In November 2005, the licensing authority issued the licence.

These premises are currently licensed for the sale of alcohol and regulated entertainment from 0700-0300 on Monday, Thursday, Friday, Saturday and 0700-0200 on Tuesday, Wednesday and Sunday

The Designated Premises Supervisor is Benjamin Rupert Lai

The expedited review added the following condition to the licence 'Only plastics and/or polycarbonates to be used for the consumption of alcohol, in addition no glassware is to be handed over the bar, all bottled drinks are to be decanted'.

7. Associated Papers

- A. Copy of Review Application
- B. Copies of supporting evidence
- C. Copy of Current Licence
- D. Representations

This page is intentionally left blank



**METROPOLITAN
POLICE**

TOTAL POLICING

Form for Applying for a Summary Licence Review

Application for the review of a premises licence under section 53A of the Licensing Act 2003

(premises associated with serious crime, serious disorder or both)

PLEASE READ THE FOLLOWING INSTRUCTIONS FIRST

Before completing this form please read the guidance notes at the end of the form. If you are completing the form by hand please write legibly in block capitals. In all cases ensure that your answers are inside the boxes and written in black ink.

Use additional sheets if necessary.

Insert name and address of relevant licensing authority and its reference number:

Name:	PC Sam Lewis-Evans 598QK		
Address:	Brent Police Licensing Brent Civic Centre Engineers Way		
Post town:	Wembley	Post code:	HA9 0FJ
Ref. No.:			

I PC Sam Lewis-Evans

on behalf of the chief officer of police for the Metropolitan Police area apply for the review of a premises licence under section 53A of the Licensing Act 2003.

1. Premises details

Postal address of premises or club premises, or if none, ordnance survey map reference or description:

No 8 Bar and Hostel
305 High Road

Post town:	London	Post code: (if known)	NW10 2 JT
-------------------	--------	----------------------------------	-----------

2. Premises licence details

Name of premises licence holder or club holding club premises certificate (if known):

TUBBY LTD.

Number of premises licence or club premises certificate (if known):

3. Certificate under section 53A(1)(b) of the Licensing Act 2003 (Please read guidance note 1)

I confirm that a certificate has been given by a senior member of the police force for the police area above that in his opinion the above premises are associated with serious crime or serious disorder or both, and the certificate accompanies this application.

Please tick the box to confirm:

4. Details of association of the above premises with serious crime, serious disorder or both

(Please read guidance note 2)

No 8 Bar and Hostel is a well established premise based in a busy High Road.

On 31/7/14 Police were called to the venue where two males had been assaulted, one being glassed in the face and the other punched multiple times. This is the second glassing incident with serious injury within 12 months (information contained in supporting document).

I reserve the right to produce evidence which amplifies the grounds for review which may take place at, or in the vicinity of the premises, between the service of this application and the hearing and/or during the time allowed for any appeal proceedings.

Signature of applicant

Signature:		Date:	4/8/14
Capacity:	Brent Police Licensing		

Contact details for matters concerning this application

Surname:	Lewis-Evans	First Names:	Sam
Address:	Brent Police Licensing, Brent Civic Centre, Engineers Way		
Post town:	Wembley	Post code:	HA9 0FJ
Tel. No.:	0208 733 3206	Email:	Sam.Lewis-Evans@met.police.uk

Notes for guidance

- A certificate of the kind mentioned in the form must accompany the application in order for it to be valid under the terms of the Licensing Act 2003. The certificate must explicitly state the senior officer's opinion that the premises in question are associated with serious crime, serious disorder or both.

Serious crime is defined by reference to section 81 of the Regulation of Investigatory Powers Act 2000. In summary, it means:

 - conduct that amounts to one or more criminal offences for which a person who has attained the age of eighteen and has no previous convictions could reasonably be expected to be sentenced to imprisonment for a term of three years or more; or
 - conduct that amounts to one or more criminal offences and involves the use of violence, results in substantial financial gain or is conduct by a large number of persons in pursuit of a common purpose.

Serious disorder is not defined in legislation, and so bears its ordinary English meaning.
- Briefly describe the circumstances giving rise to the opinion that the above premises are associated with serious crime, serious disorder, or both.

Retention Period: 7 years
MP 146/12

No 8 Bar Crimes August 2013 to August 2014

CRIS : 1918126/13 Victim was hit in the face with glass causing swelling and cut to face requiring hospital treatment 08/08/2013 0115 Assault by one customer on another whilst discussing who had the best life -8/8/13

1918297/13 By suspect punching the victim in the face after victim asked suspect's girlfriend for a lighter 10/08/2013 0310 VIW 1 is currently a guest at the No 8 hotel in Willesden. At about 0310 hours he went outside in order to smoke a cigarette. He was outside the hostel at the junction with Churchmead Road. He did not have a light on him so asked a passing female for a light. She was with Susp 1, who immediately punched him in the nose. The suspect and the female then walked off and got on a bus, towards Kilburn. VIW 1 said he had not seen the suspect before the incident - 12/8/13

1918539/14 VIW1 and 2 were in the bar drinking when approached by the SUSP who smashed a glass in VIW1 face and punched VIW2 a number of times.

31/07/2014 1840

As police were trying to deal with Suspect, ***** came around the corner. He was bleeding profusely from his head. He stated that Suspect had picked up a glass and smashed it in his face. Police attended No 8 bar where the incident happened and located ***** who had been punched in the face a number of times by Suspect, causing swelling to his left cheek and chin. *****, an independent witness in the bar, stated that he saw Suspect smash a glass in ***** face and punch ***** between 5-10 times in the face. ***** stated that once he left no 8 bar, Suspect tried to follow him and attack him again but he managed to get away from it. After SUSP had been arrested he said "ITS A BIT OF A PERSONAL BETWEEN THOSE TWO GEEZERS, I SORTED IT OUT TONIGHT" - 1/8/14

This page is intentionally left blank

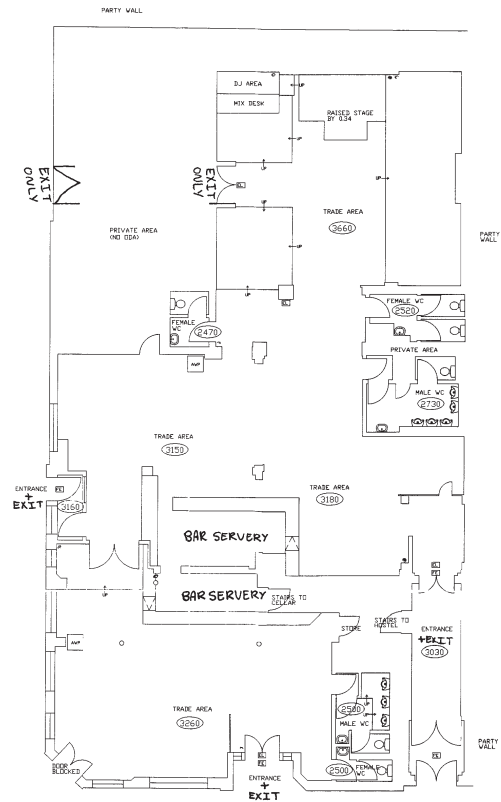

BUILDING SURVEYED AREA = 355.2 SQ. M
 ■ LOCATED IN CELLAR
 ■ LOCATED IN CELLAR
 SCALE 1:100
 GROUND FLOOR

SCALE 1:100
 FIRST FLOOR

SCHEDULE OF ADDITIONAL ACCOMMODATION

1 Number of storeys of building.	2 storeys + cellar
2 Staff accommodation.	4 bedrooms
3 Letting rooms with mini bar.	0 rooms
4 Letting rooms without mini bar.	0 rooms

- LEGEND
- CEILING HEIGHT
 - WINDOW
 - FIRE PLACE
 - DOOR
 - TOILET
 - URINAL
 - WASH HAND BASIN
 - BOILER
 - FIRE EXIT
 - EMERGENCY LIGHT
 - DISTRIBUTION BOARD
 - STEPS
 - SINK UNIT
 - AMUSEMENT WITH PRIZES
 - BAR FLAP
- EXTINGUISHER-WATER
 • EXTINGUISHER-CO2
 • FIRE BLANKET
 • DRY POWDER.

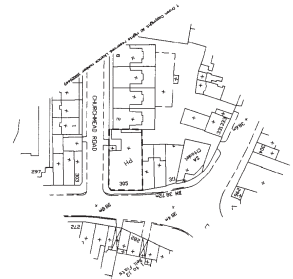

INDICATIVE ONLY
 SCALE 1:1250

Property ID	Property Name	Address	Date of Survey	Dwg. Scale
3096501/244	Ned Kellys	305 High Rd Willesden Green London NW10 2JT	03/08/04	AS SHOWN

This page is intentionally left blank

London Borough of Brent

Premises Licence

PART A

*This Premises Licence was granted by Brent Council, Licensing Authority for the area of the Borough of Brent under the **Licensing Act 2003**.*

Signed.....
Director of Environment and Culture

Date: 17 August 2007

Licence number 181042

Licence start date: 24/11/2005

Part 1 - Premises Details

No.8, 305 High Road, London, NW10 2JT
Telephone: 020 8451 3981

Licensable activities and the times authorised by this licence

Films:

Day	Start Time	End Time
Monday	07:00	03:00
Tuesday	07:00	02:00
Wednesday	07:00	02:00
Thursday	07:00	03:00
Friday	07:00	03:00
Saturday	07:00	03:00
Sunday	07:00	02:00

Indoor Sporting Events:

Day	Start Time	End Time
Monday	07:00	03:00
Tuesday	07:00	02:00
Wednesday	07:00	02:00
Thursday	07:00	03:00
Friday	07:00	03:00
Saturday	07:00	03:00
Sunday	07:00	02:00

Live Music:

Day	Start Time	End Time
Monday	07:00	02:00
Tuesday	07:00	01:00
Wednesday	07:00	01:00
Thursday	07:00	02:00
Friday	07:00	02:00
Saturday	07:00	02:00
Sunday	07:00	01:00

Recorded Music:

Day	Start Time	End Time
Monday	07:00	03:00
Tuesday	07:00	02:00
Wednesday	07:00	02:00
Thursday	07:00	03:00
Friday	07:00	03:00
Saturday	07:00	03:00
Sunday	07:00	02:00

Performances of Dance:

Day	Start Time	End Time
Monday	07:00	02:00
Tuesday	07:00	01:00
Wednesday	07:00	01:00
Thursday	07:00	02:00
Friday	07:00	02:00
Saturday	07:00	02:00
Sunday	07:00	01:00

Provision of Entertainment Facilities for Making Music:

Day	Start Time	End Time
Monday	07:00	02:00
Tuesday	07:00	01:00
Wednesday	07:00	01:00
Thursday	07:00	02:00
Friday	07:00	02:00
Saturday	07:00	02:00
Sunday	07:00	01:00

Non standard timings: From the end of permitted hours New Years Eve to the start of permitted hours on New Year Day.

Provision of Entertainment Facilities for Dancing:

Day	Start Time	End Time
Monday	07:00	02:00
Tuesday	07:00	01:00
Wednesday	07:00	01:00
Thursday	07:00	02:00
Friday	07:00	02:00
Saturday	07:00	02:00
Sunday	07:00	01:00

Non standard timings: From the end of permitted hours on New Years Eve to the start of permitted hours on New Years Day.

Provision of Late Night Refreshment:

Day	Start Time	End Time
Monday	23:00	03:00
Tuesday	23:00	02:00
Wednesday	23:00	02:00
Thursday	23:00	03:00
Friday	23:00	03:00
Saturday	23:00	03:00
Sunday	23:00	02:00

Supply of Alcohol:

Day	Start Time	End Time
Monday	07:00	02:00
Tuesday	07:00	01:00
Wednesday	07:00	01:00
Thursday	07:00	02:00
Friday	07:00	02:00
Saturday	07:00	02:00
Sunday	07:00	01:00

Non standard timings: Christmas Eve permitted hours from 07.00hrs to 01.00hrs (the following day)

Whether alcohol is authorised to be supplied on or off the premises: **Both**

The Opening Hours of the Premises:

Day	Start Time	End Time
Monday	07:00	03:00
Tuesday	07:00	02:00
Wednesday	07:00	02:00
Thursday	07:00	03:00
Friday	07:00	03:00
Saturday	07:00	03:00
Sunday	07:00	02:00

Non standard timings: Christmas Eve permitted hours from 07.00hrs to 02.00hrs (the following day)

To remain open for the carrying on of licensable activities from the end of permitted hours on New Year's Eve to the commencement of permitted hours on the day following under the Licensing Act 1964

Part 2

Details of Holder of Premises Licence:

Name: Tubby Limited

Address: 305 High Road, Willesden, NW10 2JT

Registered Address: 305 High Road, Willesden, London, NW10 2JT

Registered Number: 5623690

Details of Designated Premises Supervisor:

Name: Benjamin Rupert Lai

Address: 26 Wormholt Road, Shepherds Bush, London , W12 0LS

Personal Licence Number: 2006/03931/LAPER

Issuing authority: London Borough of Hammersmith & Fulham

Annexe 1 - Mandatory Conditions

(a) No supply of alcohol may be made at a time when no designated premises supervisor has been specified in the licence or at a time when the designated premises supervisor does not hold a personal licence or his or her licence has been suspended.

(b) Every supply of alcohol under the premises licence must be made or authorised by a person who holds a personal licence.

All persons present on the premises who are required to carry out a security activity must be licensed by the Security Industry Authority.

Admission of children must be restricted according to film classification.

Embedded Conditions

Not Applicable

Annexe 2 - Conditions Consistent With the Operating Schedule

1. CCTV shall be installed and maintained in a working condition.
2. All CCTV recordings shall be kept for 31 days and shall be made available to police and licensing officers if requested.
3. The total number of people permitted on the premises including staff and performers shall not exceed 290.
4. The licensee shall make available to customers all toilets shown on the plans accompanying this licence.
5. No entry or re-entry shall be permitted after 01:00 hours.
6. No children shall be permitted on the premises after 21:00 hours
7. Noise levels of music shall be arranged so as not to cause a nuisance to local residents.
8. Notices requesting customers to leave quietly shall be displayed at each exit.

9. Announcements shall be made at the end of each performance asking customers to leave quietly.
10. Performers shall be instructed to create minimum nuisance when entering or leaving the building.
11. All doors exiting on to Churchmead Road shall be closed at 21:30 hours and all customers are to leave via the High Road except in an emergency.
12. The licensee shall ensure that musicians load/unload their equipment at the beginning of Churchmead Road and then enter/leave the premises via the High Road entrance/exit.
13. The management shall provide local residents with a direct telephone number of the premises.
14. There shall be a minimum of 2 door supervisors on Sunday to Thursday and 3 Friday and Saturday, 2 shall be to control entrance to the premises and 1 to control order within the premises.
15. The licensee or his/her deputy shall be a member of, and actively participate in the local pubwatch scheme.
16. Photographic proof of age shall be required from anyone who arrears to be below the age of 18.

Annexe 3 - Conditions Attached After a Hearing by the Licensing Authority

1. The applicant shall adhere to a maximum capacity limit for the premises of 290 persons and that the applicant shall make available to customers all toilets shown in the plans submitted with the application, at all times when the premises are open to the public.
2. Children under 16 years of age shall not be permitted on the premises at all after 21:00 (i.e. regardless of whether they are accompanied by an adult) on any day that the premises are open to the public.
3. The applicant shall not allow customers to enter or re-enter the premises after 01:00 on any day when the premises are open to the public.

Annexe 4 - Plans

See attached sheet.

This page is intentionally left blank